

# GHILOTTI CONSTRUCTION COMPANY

San Rafael Division  
2301 Kerner Blvd., Suite E  
San Rafael, California 94901-5567  
Telephone: (415) 256-1525  
FAX: (415) 256-1520

## LETTER OF TRANSMITTAL

**TO: California Department of Transportation**  
**48499 Milmont Drive**  
**Fremont, CA 94538-7327**

**Re: Hwy. 84 Niles Canyon**  
**Contract No: 04-174414**  
**GCC Job No. 5363**

**ATTN: Siavosh Moghadam, P.E. Resident Engineer**

DATE: February 10, 2011

**SUBMITTAL NO. 001**

WE ARE SENDING YOU THE FOLLOWING DOCUMENTS VIA  U.S. MAIL  FAX  Email  
FOR ACTION OR USE AS INDICATED:

- For approval or action                       For your files or information                       For review and comment  
 Sign & return one copy                       As Requested                       See note below

Number of Copies	Date	Description
	2/10/2011	Interim SWPPP (Tree Cutting Only)

NOTE: ATTACHED PLEASE FIND THE INTERIM SWPPP FOR TREE CUTTING ONLY.

Very truly yours,  
Ghilotti Construction Company



By \_\_\_\_\_  
John Preston, Project Engineer

INTERIM  
**STORM WATER POLLUTION PREVENTION PLAN**  
**FOR TREE CUTTING AND REMOVAL ONLY**

For:

Contract # 04-17441

**California Route 84**

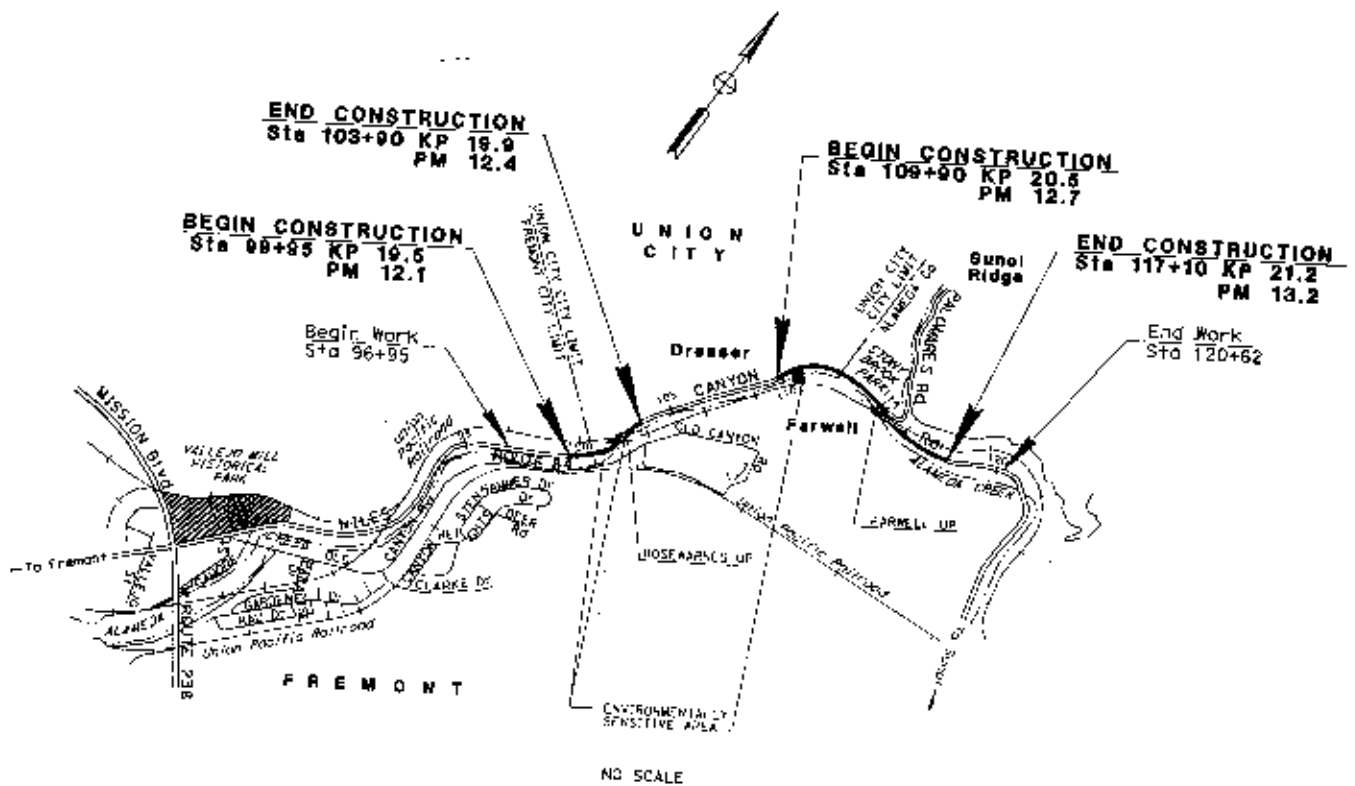

**Overall Project Description:** Highway 84 is a main arterial in the Bay Area which extends from Highway 101 in Palo Alto to Highway 680 in Livermore. The purpose of this project is to realign portions of the highway along the Niles Canyon Road segment to improve site distance. This will require widening of the existing highway resulting in the need to remove some existing foliage and build some new retaining walls.

**Scope of Work (Tree Cutting Only):** In order to avoid the bird nesting season it has been mutually agreed that Ghilotti Construction will remove the existing trees in two phases. The first phase will be to cut the trees down to a stub height of 4 to 5 feet before the bird nesting season begins. (This work will be performed on the week of February 14, 2011). The second phase of tree removal (removal of stumps) will occur with the clearing and grubbing phase (Starting after June 15, 2011). Cutting the trees down now will eliminate any problems caused by birds nesting in the trees; which would likely cause substantial project delays.

**Execution of Work:** The process of cutting the trees will be performed at nighttime only. It will require closure of one lane in order to accommodate equipment and trucks associated with this process. The lane closure will be performed in accordance with Caltrans specifications. All equipment and trucking will be restricted to the roadway only. Equipment used during this process includes a hydraulic excavator, chain saws, and dump trucks. There will be no encroachment of either trucks or equipment into the creek bed or environmentally sensitive areas. This work will not result in the disturbance of any soil. ~~The trees will be cut down and immediately loaded onto trucks for offsite disposal.~~ The trees will be cut down in such a fashion that they do not fall into the water side; resulting in possible soil disturbance. Smaller trees will be manually restrained via hand or via a sling or rope. Larger trees will be restrained by using a sling attached to a hydraulic excavator prior to making a cut. These trees will then immediately be loaded onto trucks and off hauled (See Attachment 3).

An initial assessment of the site has shown that the terrain is very rocky and not likely to experience soil erosion. However, Caltrans will evaluate the soil conditions in the areas of tree removal to determine if there is the potential for soil erosion resulting from the loss of the tree canopy. If the potential for soil erosion is identified, a plan to mitigate the potential erosion will be prepared and implemented. Additionally, if any accidental soil disturbance occurs, the site will be restored to original condition by the end of the work shift.

**Stormwater BMP's:** Since this work will be performed from the existing paved surface and no soil will be disturbed; no extensive SWPPP measures will be needed. Ghilotti Construction will ensure that good housekeeping techniques are employed during the tree cutting process, and that the area remains in the same conditions in which it was encountered. No construction debris, tools, or garbage will be left behind as a result of this work.

**Map or Areas of Work:** Attached, please find a map of the proposed areas of work. Approximate distances the creek will be given.

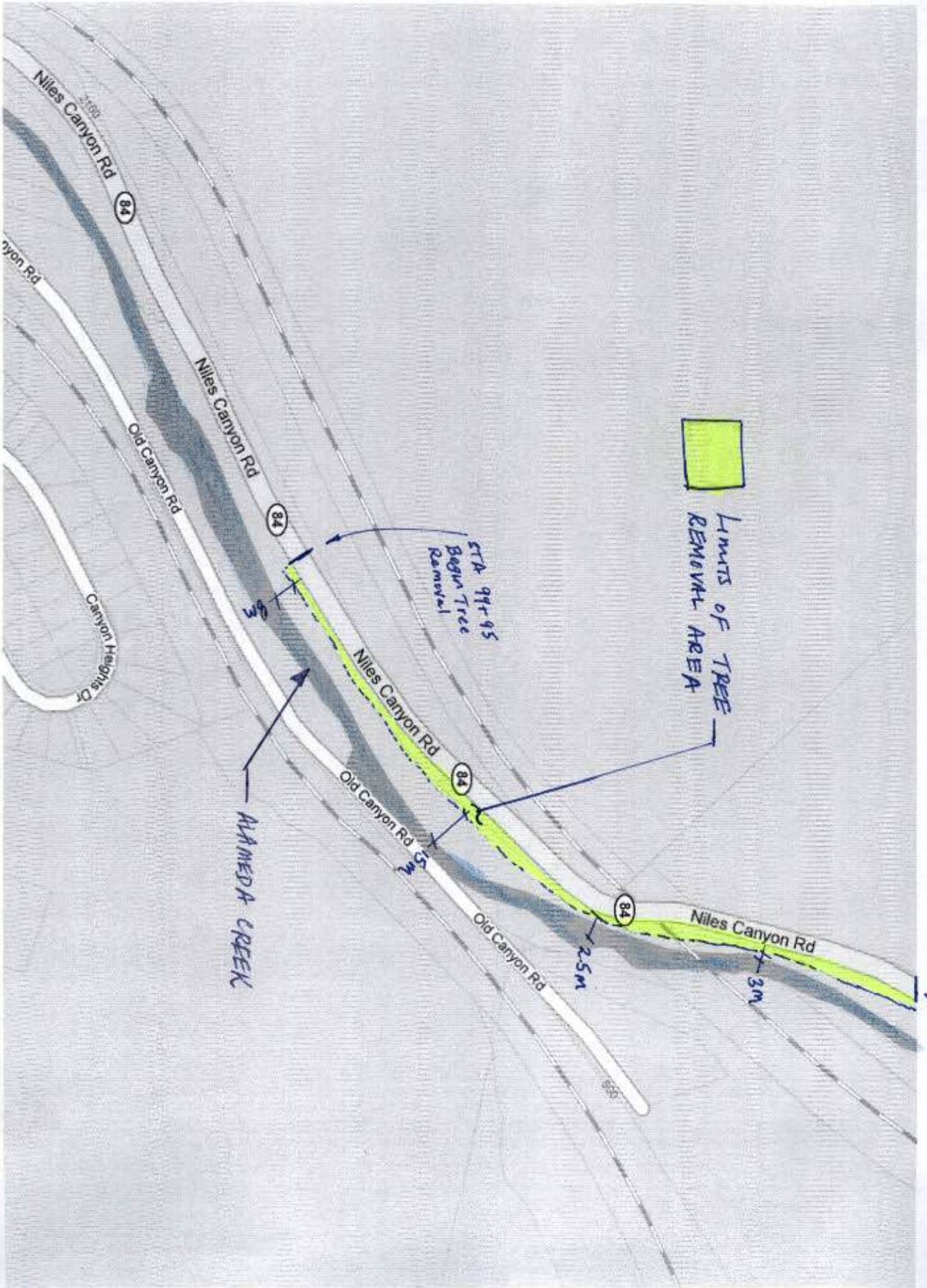



  
 LIMITS OF TREE
   
 REMOVAL AREA

STA 94+95
   
 BEGIN TREE
   
 REMOVAL

ALAMEDA CREEK

STA 103+90
   
 END TREE
   
 REMOVAL

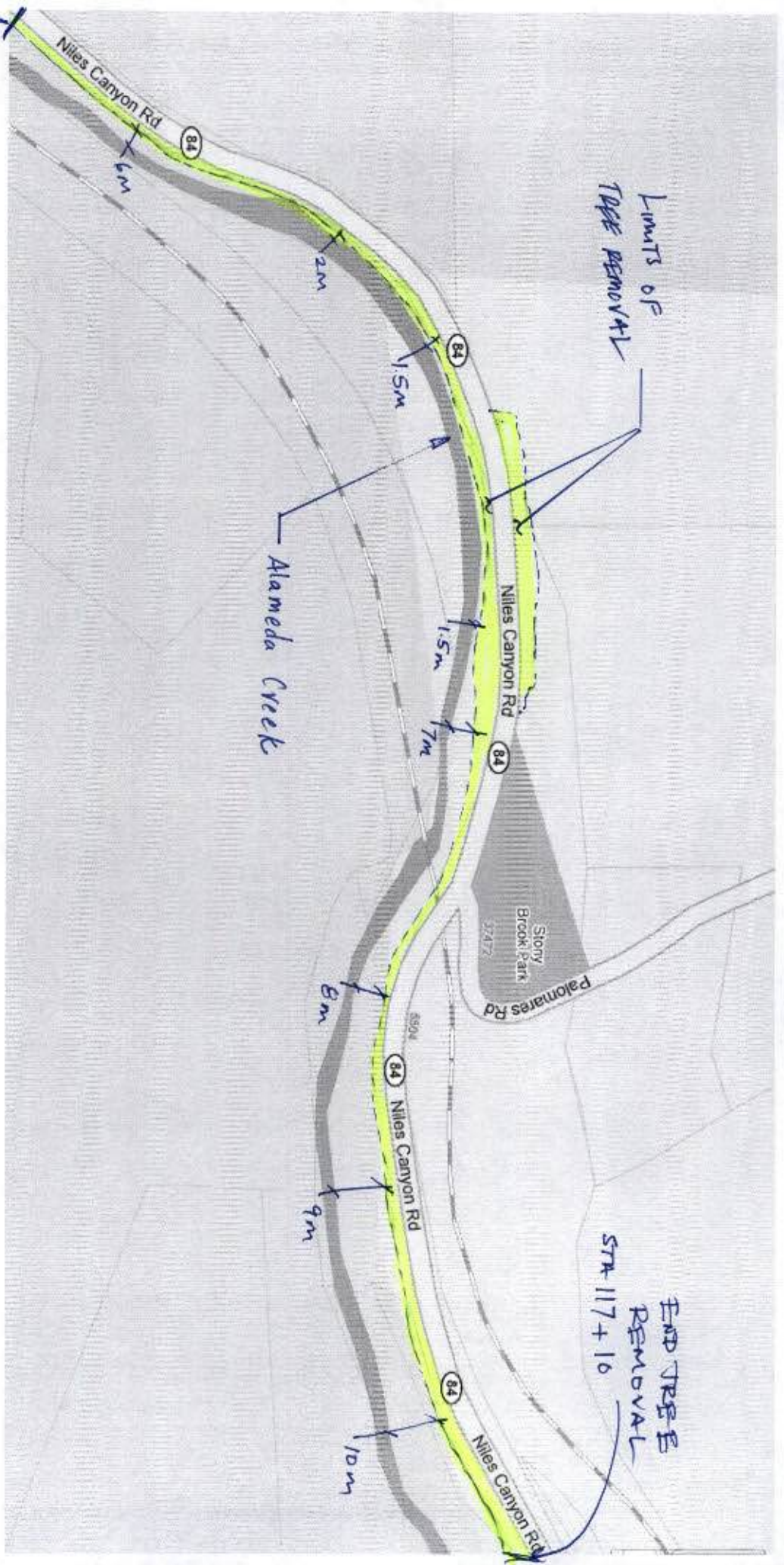
Begin Tree Removal  
STA 109+90



Limits of  
TREE REMOVAL

Alameda Creek

END TREE  
REMOVAL  
STA 117+10

TWO WAY REVERSING  
TRAFFIC CONTROL

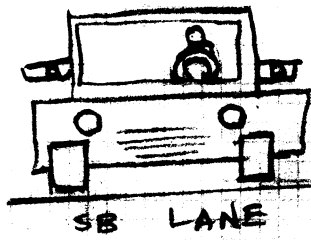

SB LANE

LANE  
CLOSED



EX Guard Rail

SLING

CHAIN  
SAW

ALAMEDA  
CREEK

REMOVAL OF SMALL TREES  
NTS

TWO WAY REVERSING  
TRAFFIC CONTROL

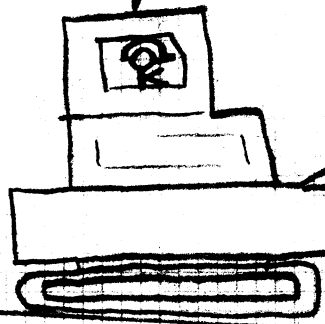
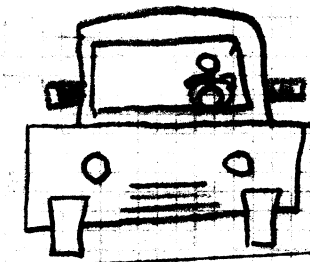

Hydraulic  
Excavator

SLING

CHAIN  
SAW

ALAMEDA  
CREEK

REMOVAL OF LARGE TREES  
NTS